



# HOW TO: WASH WALLS

## TOOLS



Quick Connect Handle of Choice



Flexible Head Duster



11" or 18" Quick Connect Frame



Safety Sign

11" Wall/  
Stair Pad  
or  
18"  
Scrubber  
Pad  
or  
18" Dust  
Pad



Press Wring  
Bucket • Q900-88



or Pedal Wring  
Bucket • Q920

Cleaning Solution of Choice

## WALL PREPARATION

High dust walls before washing starting at ceiling in far corner of room. Use adjustable handle for reach if necessary.

Dust room from the top down always moving toward the doorway.

## WALL WASHING PROCEDURE

- 1** Affix mop handle to frame.
- 2** Place a clean Wet Pad on the floor with white backing side up.
- 3** Hold Quick Connect Frame over the pad then slide it down to attach pad with hook and loop system.
- 4** Fill bucket to desired level with water and recommended volume of cleaning solution.
- 5** Place microfiber flat mop into bucket and maneuver bucket to desired location by steering with mop handle.
- 6** Set up the floor safety sign.
- 7** **8** Lift mop from bucket onto sieve and wring pad to desired wetness. Bucket should not move. Rotate pad 180° and wring from other side to prevent dripping. You may also use Pedal Wring Bucket.
- 9** Starting at the ceiling in a far corner or end of hall, use long, even, vertical strokes to clean. Overlap strokes slightly to insure coverage.  
  
Working backwards toward the doorway, repeat Steps 7 & 8 as needed to complete the job. Note: Change pad when too soiled to clean.
- 10** To empty bucket, pour contents into drain using twist valve on back side of bucket or pour contents into sink using one of the corners as a pouring spout.
- 11** Rinse pad well with clean water or remove pad from frame for laundering using one of two methods:
- 12** Method #1: Using fabric loop on pad, peel pad away from hook and loop fastening on frame. Wash or dry as needed.
- 13** **14** **15** Method #2: Step on edge of pad frame with left foot and edge of pad with right foot. Pull frame up and pad will peel away from hook and loop backing. Lift soiled pad by turning frame 90° and touching end of frame on center of pad to lift up. Since pad now folds downward in half, it can easily be removed from the frame and dropped into a laundry bag.

## TIPS

- For best results use an adjustable handle with smaller size frame and pads for better reach and control.
- Follow all established safety procedures.
- Wear all appropriate personal protective equipment (glasses, gloves, etc.).

**OVER**

# HOW TO: Wash Walls

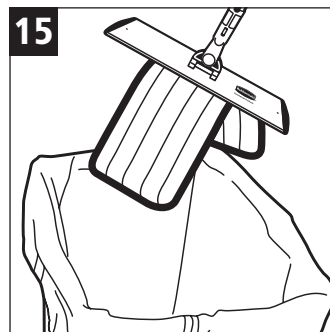
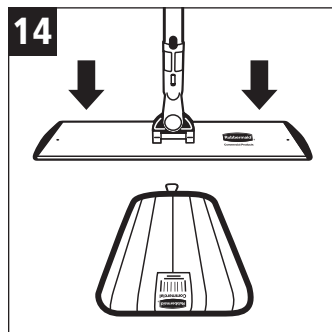
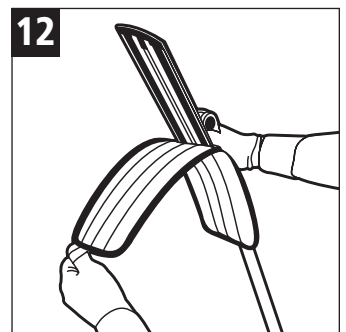
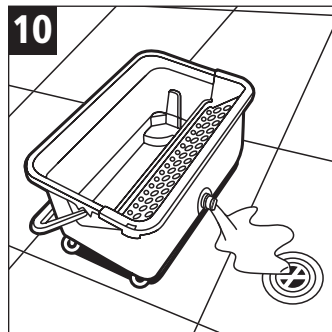
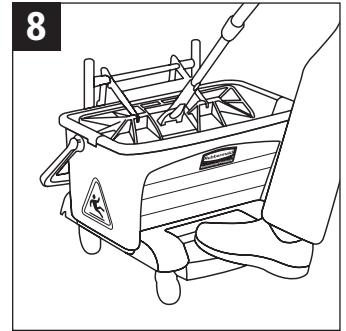
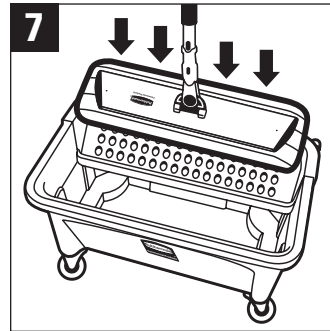
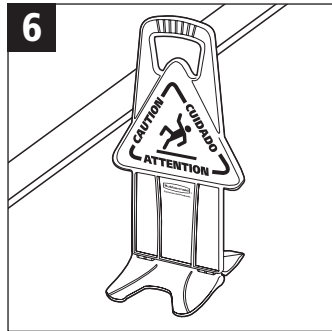
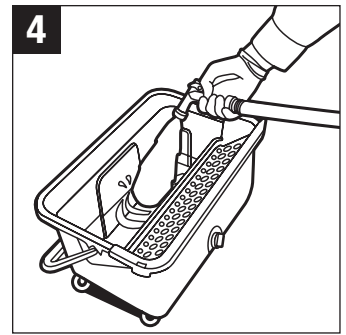
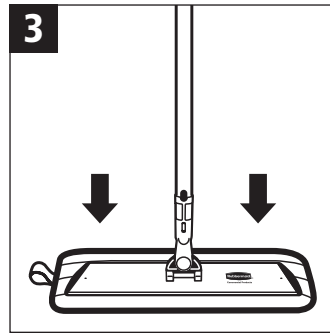
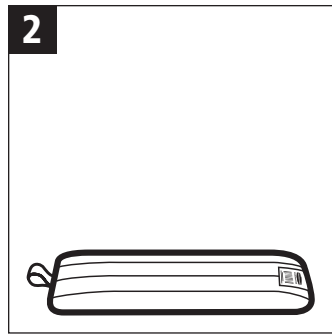
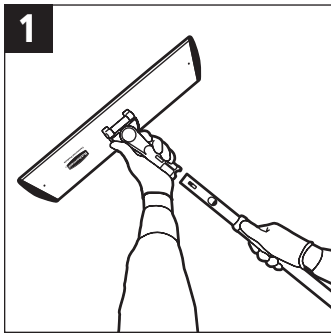

Customer Service: 1-800-347-9800  
www.rubbermaidcommercial.com

03/06 MP 20M SM664-I  
©2006 by Rubbermaid Commercial Products LLC  
3124 Valley Avenue, Winchester, VA 22601

**Work Smarter.**

