

Sealed Air Instapak Quick® RT

Foam Packaging

User's Guide



Introduction

Welcome to the *Instapak Quick® RT (Room Temperature) Foam Packaging User's Guide*.

For best results use **Instapak Quick® RT** foam packaging at room temperature (65° - 90° F / 18° - 32°C).

Instapak Quick® RT foam packaging is a fast, flexible, and easy-to-use packaging method that provides superior protection for your products. It is ideal for cushioning, blocking and bracing applications, and for producing molded cushions.

Each **Instapak Quick® RT** bag contains two separate liquids (Components "A" and "B") that, when mixed together, will react and expand to form polyurethane foam packaging. This foam is designed to provide package protection for a wide range of products and product weights.

Read and thoroughly understand the information about safety and proper use of this product contained in this *User's Guide*.

For additional information on using **Instapak Quick® RT** Foam Packaging, see our website at:
www.instapakquick.com

Safe Product Usage

WARNING!
Before using this product, read and familiarize yourself with important safety and instructional information that is found in the *Material Safety Data Sheets (MSDSs)*, the *product label band*, and this *User's Guide*.

CAUTION!
Safety glasses with side shields should be worn while using **Instapak Quick® RT** foam packaging.

WARNING!
Do not grip, squeeze, or twist the bags to activate. Always place on a firm, flat surface and press firmly on the **COMPONENT "A"** symbol to begin the activation process.

- WARNING!**
- Never apply pressure to help force the foam mixture out into the larger bag.
 - Keep bags out of reach of children.
 - Puncturing or tearing any part of the bag before mixing may cause liquid component leakage or could result in foam escaping the bag after activation.
 - Unactivated bags should never be taken from the packaging workplace.
 - Always use **Instapak Quick® RT** bags in a well ventilated area.
 - Avoid being in the direct path of off-gassing steam to optimize user safety and comfort. This steam is very warm.

Who to Call "For Chemical Emergency"

Spill, Leak, Fire, Exposure or Accident
call CHEMTREC - 24 Hours
1-800-424-9300

Environmental Information

Instapak Quick® RT foam packaging minimizes the amount of packaging material used without compromising the protection of goods shipped. **Instapak Quick® RT** foam packaging is produced without chloro-fluorocarbons (CFCs) or hydrochlorofluorocarbons (HCFCs), which have been associated with the depletion of the ozone layer.

- **Source Reduction**
Instapak Quick® RT foam provides superior cushioning that maximizes protection with a minimum amount of material. Less packaging is used, so less enters the waste stream.
- **Reuse**
For companies shipping the same product from location to location, **Instapak Quick® RT** foam packaging can be used for multiple trips. **Instapak Quick® RT** foam cushions can be reused as carton filler or reshaped manually to fit other products for shipping.
- **Return**
Multiple locations have been established in the United States and around the world where **Instapak Quick® RT** foam cushions can be returned. To find the location nearest you, call toll-free 1-800-982-6197 (U.S. and Canada).
- **Waste to Energy Efficiency**
Instapak Quick® RT foam packaging is an excellent fuel source for municipal waste-to-energy facilities.
- **Landfill Compatibility**
Highly compressible, **Instapak Quick® RT** foam occupies only 10% of its original volume when disposed of in a landfill.

To Start a Bag (Note: Refer to *Packing Tips* on the reverse side prior to use.)

Remove the Outer Wrapper

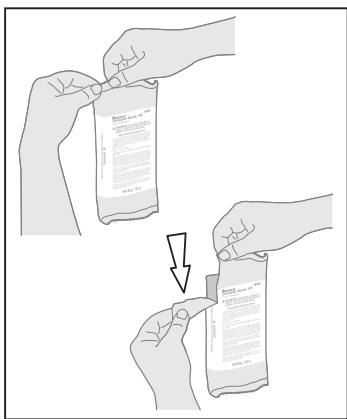

Prepare the shipping box and item to be packed.

Read the information on the outside of the wrapper.

Open the wrapper by tearing down from the top.

WARNING!
To prevent damage due to puncture, never use a sharp object to remove the wrapper around the bag.

CAUTION!
Safety glasses with side shields should be worn while using **Instapak Quick® RT** foam packaging.

For additional information on using **Instapak Quick® RT** Foam Packaging, see our website at:
www.instapakquick.com

Bag Activation Step 1

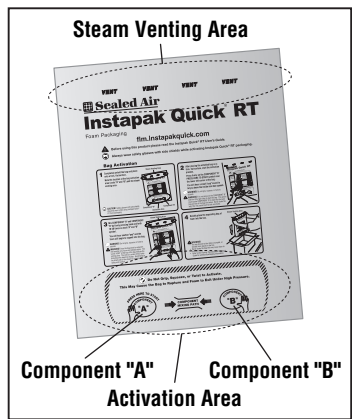

Completely unfold the bag and place onto a firm, flat surface.

Note the location of the bag activation area (ovals "A" and "B") and the steam venting area.

See the *Safe Product Usage* section of this *User's Guide* and the enclosed *MSDS* sheets for more information.

Step 2

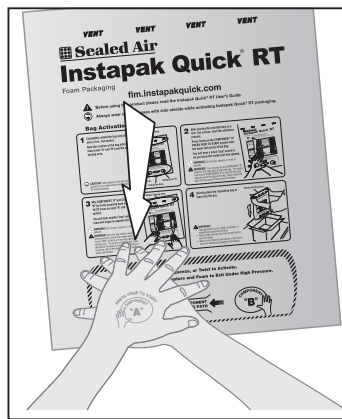

After placing the unfolded bag on a firm, flat surface, start the activation process.

Press firmly on the **COMPONENT "A" PRESS HERE TO START** symbol near the lower left corner of the bag.

You will hear a small "pop" sound to let you know the inside seal has opened.

WARNING! Do not grip, squeeze, or twist to activate.

WARNING! Do not press on the **COMPONENT "B"** side first (the right side) to start the bag. This action could cause **COMPONENT "B"** to leak into the outer bag and out of the bag vent holes. Never shake the bag; this may cause foam to exit vent holes.

Step 3

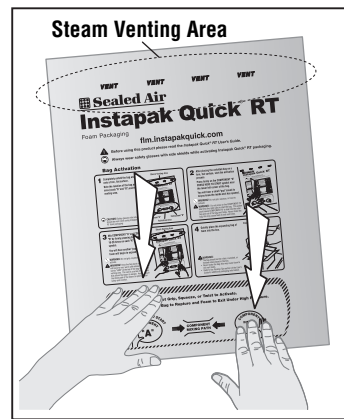

Mix **COMPONENT "A"** and **COMPONENT "B"** by firmly pressing back and forth 10-20 times on each "A" and "B" symbol.

You will hear another "pop" and the foam will begin to expand into the bag.

WARNING! Do not grip, squeeze, or twist to activate.

WARNING! Once the bag starts to expand it will become very warm and release steam. The words "VENT" at the top of the bag indicate the venting area. The vent is a series of tiny holes that allows the steam to escape. Avoid being in the direct path of the steam to optimize user safety and comfort.

Step 4

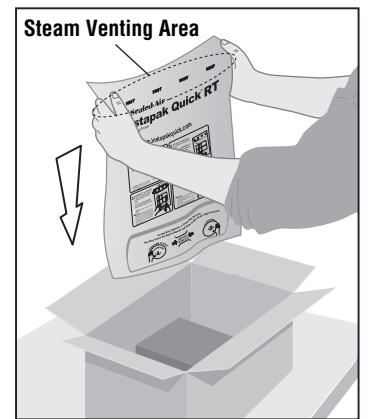

Quickly place the expanding bag of foam into the box.

WARNING!

- The bag should not be rolled, crumpled, or twisted when placed in the box.
- Never shake the bag; this may cause foam to exit vent holes.
- Refer to *Packing Tips* for additional packaging information (reverse side).

Packing Tip - Cushioning

Cushioning

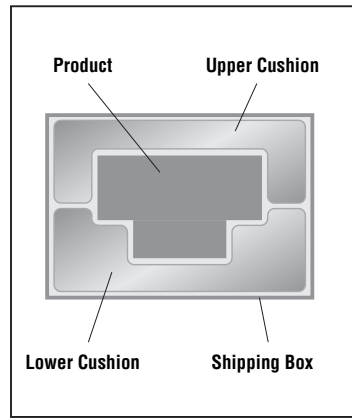

Cushioning material is used to protect delicate products packed inside shipping boxes. Cushioning is created with Instapak Quick® RT foam-filled bags by securing a product between two or more expanded foam bags.

- Note:**
- For adequate protection, most products generally require 2 inches or more of foam between your product and the wall of the shipping box.
 - Instapak Quick® RT eliminates the need to double box your product.
 - Bags will not fill completely with foam. The bags are designed to have air space at the top of the bag to allow for venting to take place and for foam to rise freely around your product.

Step 1

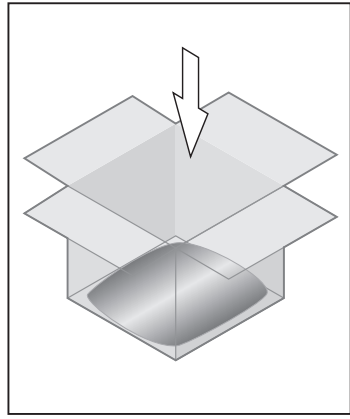

Have your product ready to be placed in the box.

Activate a bag as described on the reverse side.

Place the expanding bag of foam in the bottom of the shipping box.

- Note:** The foam rises very quickly. You will need to place your product on the rising bag of foam immediately.

CAUTION! Safety glasses with side shields should be worn while using Instapak Quick® RT foam packaging.

Step 2

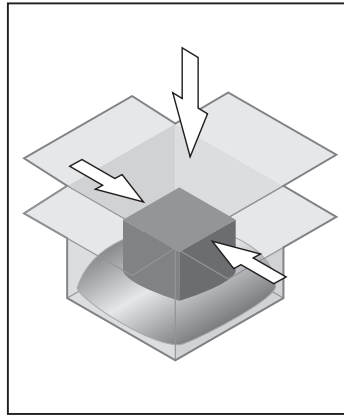

As the foam inside the bag begins to rise, nestle your product into the center of the expanding foam bag. Some continued support of your product may be necessary as the foam cures.

Allow the bag to rise up and around your product.

- Note:** Do not let your product drop to the bottom of the box. This would result in no foam protection under your product.

Let go of your product once the foam stops expanding.

The foam should support your product's weight.

- Note:** For heavy products, additional support time may be required.

Step 3

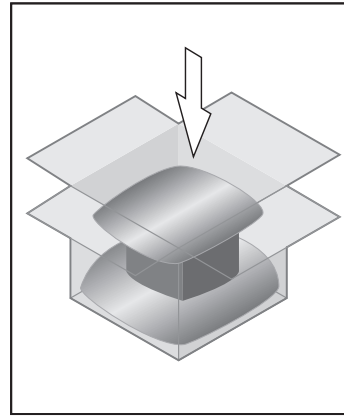

Activate additional bags as described on the reverse side.

Place the expanding bag of foam on top of your product.

Close the top flaps of the box while the foam is rising to secure your product in place.

Additional bags may be needed to properly secure your product.

The foam bag(s) will expand against the box flaps to form a custom-fit top cushion.

- Note:** Due to their shape and size, some products may require more than two Instapak Quick® RT foam bags for adequate protection. This is common when using this foam-in-bag packaging technique.

Step 4

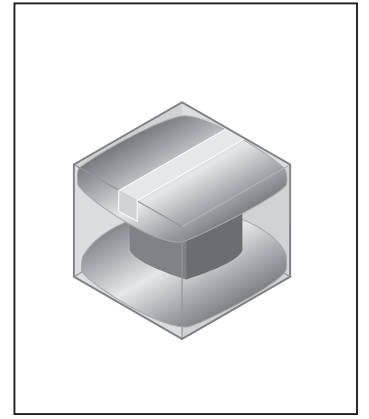

Seal the box.

For additional information on using Instapak Quick® RT Foam Packaging, see our website at: www.instapakquick.com

Packing Tip - Blocking and Bracing

Blocking and Bracing

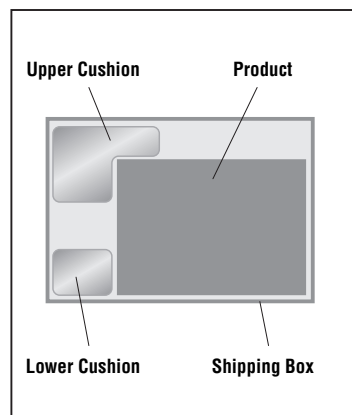

Blocking and bracing material is used to secure rugged products from moving or shifting within the shipping box. Blocking and bracing is created with Instapak Quick® RT foam-filled bags by locking the product into position using one or more corner cushions.

- Note:** Bags will not fill completely with foam. The bags are designed to have air space at the top of the bag to allow venting to take place and for foam to rise freely around your product.

Step 1

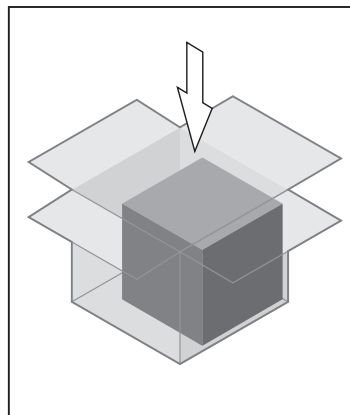

Place your product in the shipping box.

Your product may be pushed to a corner (as shown) or placed in the center of the box.

CAUTION! Safety glasses with side shields should be worn while using Instapak Quick® RT foam packaging.

Step 2

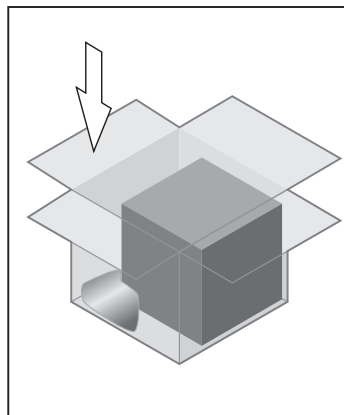

Activate a bag as described on the reverse side.

Place the expanding bag between the lower corner(s) of your product and the box.

- Note:** The foam rises very quickly. You will need to place the expanding bag of foam into the box immediately.

Let the bag expand against your product and the box walls, locking your product in place.

Step 3

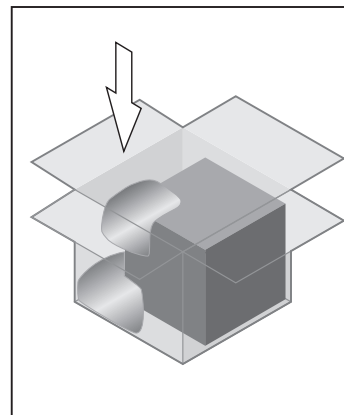

Activate additional bags as described on the reverse side.

Place the expanding bag between the upper corner(s) of your product and the box.

Let the bag expand against your product and the box walls, locking your product in place.

Place additional bags between your product and the box walls as needed.

Close the top flaps of the box while the foam is rising to secure your product in place.

Step 4

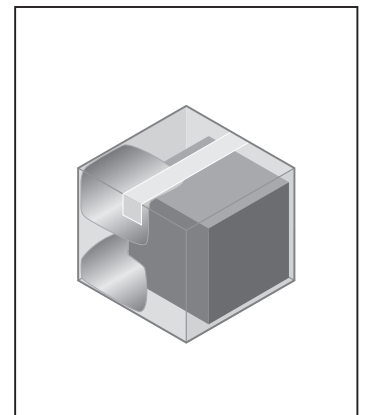

Seal the box.

For additional information on using Instapak Quick® RT Foam Packaging, see our website at: www.instapakquick.com

Sealed Air

Protective Packaging
10 Old Sherman Turnpike
Danbury, CT 06810
203-791-3500 Fax: 203-791-3618
www.sealedair.com

Our Products Protect Your Products®

Corporate Office: Sealed Air Corporation (US)
200 Riverfront Boulevard, Elmwood Park, NJ 07407 www.sealedair.com
© Reg. U.S. Pat. & TM Off. © Sealed Air Corporation (US) 2008. All rights reserved. Printed in the U.S.A.
The "9 Dot Logo" and "Sealed Air" are registered trademarks of Sealed Air Corporation (US).

Instapak Quick® RT User's Guide
T-160 Rev. D 01-08